

NOTES:  
 1. MATERIAL OF CONSTRUCTION IS 304 SS, BRUSHED #4.



PEDESTALPRO.COM  
 1-800-660-3072

UNLESS OTHERWISE SPECIFIED:

DIMENSIONS ARE IN INCHES  
 TOLERANCES:  
 FRACTIONAL  $\pm 1/32$   
 ANGULAR:  $\pm 2^\circ$   
 TWO PLACE DECIMAL  $\pm 0.010$   
 THREE PLACE DECIMAL  $\pm 0.005$

INTERPRET GEOMETRIC  
 TOLERANCING PER:  
 ASME Y14.5 -2009

| NAME     | DATE |
|----------|------|
| DRAWN PE |      |
| CHECKED  |      |

**PROPRIETARY AND CONFIDENTIAL**  
 THE INFORMATION CONTAINED IN THIS DRAWING IS THE SOLE PROPERTY OF PEDESTALPRO LLC. ANY REPRODUCTION IN PART OR AS A WHOLE WITHOUT THE WRITTEN PERMISSION OF PEDESTALPRO LLC IS PROHIBITED.

TITLE:  
**INSTALLATION**

Monday, September 8,  
 2025 3:15:39 PM

WEIGHT: 33.551

| SIZE     | PART NO.          | REV          |
|----------|-------------------|--------------|
| <b>A</b> | 64TOW-DORK-01-304 | <b>A</b>     |
| NO SCALE |                   | SHEET 1 OF 7 |

| ITEM NO. | PART NUMBER       | DESCRIPTION                      | QTY. |
|----------|-------------------|----------------------------------|------|
| 1        | 64TOW-DORK-01-304 | TOWER WELDMENT                   | 1    |
| 2        | PLTCAP-46-46-30   | CAP                              | 1    |
| 3        | PLTACC-510        | ACCESS PANEL                     | 1    |
| 4        | PLTBAS-46-46      | BASE PLATE                       | 1    |
| 5        | --                | 8-32 X 1/2" SS BUTTON HEAD SCREW | 4    |

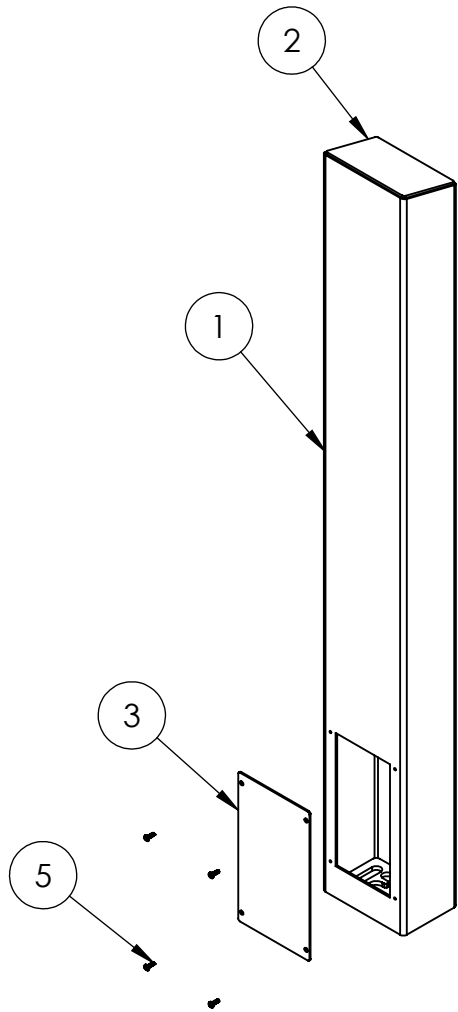

NOTES:

- SEE STANDARD PREPARATION AND COATING INSTRUCTIONS FOR COATING PROCEDURE AND COLOR.
- SEE STANDARD PACKAGING INSTRUCTIONS FOR PACKAGING PROCEDURE.



PEDESTALPRO.COM  
1-800-660-3072

UNLESS OTHERWISE SPECIFIED:

DIMENSIONS ARE IN INCHES  
TOLERANCES:  
FRACTIONAL  $\pm 1/32$   
ANGULAR:  $\pm 2^\circ$   
TWO PLACE DECIMAL  $\pm 0.010$   
THREE PLACE DECIMAL  $\pm 0.005$

INTERPRET GEOMETRIC  
TOLERANCING PER:  
ASME Y14.5 -2009

| NAME | DATE |
|------|------|
|      |      |
|      |      |

|         |  |
|---------|--|
| DRAWN   |  |
| CHECKED |  |

**PROPRIETARY AND CONFIDENTIAL**  
THE INFORMATION CONTAINED IN THIS DRAWING IS THE SOLE PROPERTY OF PEDESTALPRO LLC. ANY REPRODUCTION IN PART OR AS A WHOLE WITHOUT THE WRITTEN PERMISSION OF PEDESTALPRO LLC IS PROHIBITED.

TITLE:

ASSEMBLY

Monday, September 8,  
2025 3:15:39 PM

WEIGHT: 33.551

SIZE  
**A**

PART NO.  
64TOW-DORK-01-304

REV  
**A**

NO SCALE

SHEET 2 OF 7